

| BBL  | Description                 | QTY | Part Number | BBL  | Description                      | QTY | Part Number |
|------|-----------------------------|-----|-------------|------|----------------------------------|-----|-------------|
| 001  | OWNER'S MANUAL              | 1   | P711-001    | 073  | SET FORK                         | 1   | 101-110-21L |
| 002  | SCREW - P (M6*P1.0*L12)     | 6   | 002-211-282 | 074  | PLATE STICKER - 5KG (GREEN)      | 1   | S912-047    |
| 003  | TOP COVER - RIGHT           | 1   | P711-003    | 075  | PLATE STICKER - 10-60KG (GREEN)  | 1   | S911-048    |
| 007  | BRACKET                     | 2   | 101-110-290 | 076  | PLATE STICKER - 65-100KG (GREEN) | 1   | S911-049    |
| 007R | BRACKET                     | 1   | 101-110-300 | 077  | GUIDE RING                       | 2   | P711-077    |
| 007S | SCREW - M/P (M5*0.8*L8)     | 2   | 002-209-130 | 078  | SCREW - B/P (M5*L12)             | 4   | 002-207-140 |
| 008  | SCREW - M/P (M4*L12)        | 2   | 002-210-003 | 082  | SCREW - B/H (M6*P1.0*L15)        | 4   | 002-205-613 |
| 009  | TOP COVER - LEFT            | 1   | P711-009    | 083  | WEIGHT STACK CUSHION             | 2   | P711-083    |
| 010  | STICKER - USAGE             | 1   | P711-010    | 086  | SELECTOR FORK - NO CORD          | 1   | 190-553-052 |
| 011  | SINGLE-SIDED TAPE           | 3   | 000-065-350 | 087  | NUT - H (M4*P0.7)                | 2   | 001-102-090 |
| 012  | STICKER - WARNING           | 1   | DF-101-008  | 088  | RETRACTING CABLE                 | 1   | DF-100-021  |
| 013  | PULLEY                      | 1   | A971-08     | 089  | SCREW - P (M4*P0.7*L25)          | 2   | 002-211-080 |
| 014  | AXLE                        | 1   | DF-100-032  | 095  | AXLE                             | 1   | DF-101-122  |
| 016  | WASHER - F (D20*D6.3*T1.5)  | 2   | 003-301-043 | 096  | NUT - H (M10)                    | 1   | 001-102-141 |
| 017  | WASHER - SP (M6)            | 2   | 003-302-011 | 097  | WEIGHT PLATE - 3.7KG             | 3   | P711-097    |
| 018  | SCREW - M/H (M6*P1.0*L12)   | 2   | 002-203-027 | 100  | END CAP                          | 2   | A933-41     |
| 019  | SCREW - M/H (M6*P1.0*L12)   | 6   | 002-203-027 | 101  | SCREW - H (M5*L5)                | 4   | 002-204-064 |
| 019R | COVER WASHER - (D21.5*10.5) | 1   | DF-101-030A | 102  | RUBBER GRIP                      | 2   | DF-102-049  |
| 019S | SCREW - P (M6*P1.0*L20)     | 1   | 002-213-035 | 103  | HANDLEBAR RING                   | 2   | A931-40     |
| 020  | BRACKET                     | 3   | 105-710-210 | 105  | SCREW - B/H (M6*L8)              | 2   | 002-205-601 |
| 020R | FOAM RING                   | 1   | 005-757-720 | 106  | WASHER - SP (M6*T1.5)            | 2   | 003-302-002 |
| 021  | STICKER - WARNING           | 1   | DF-101-020D | 107  | RUBBER GRIP                      | 2   | P711-107    |
| 022  | COVER FRAME - GREY          | 1   | P711-022G   | 139  | SCREW - B/H (M8*P1.25*L20)       | 2   | 002-205-820 |
| 023  | SCREW - M/P (M5*0.8*L8)     | 5   | 002-209-137 | 140  | WASHER - F (D26*D8.3*T3)         | 2   | 003-301-027 |
| 026  | COVER FRAME - GREY          | 1   | P711-026G   | 140R | WASHER - (D31*D20.2*T3.0)        | 2   | 103-301-162 |
| 027R | SCREW INSERT                | 10  | 000-076-820 | 140S | SCREW - B/H (M8*P1.25*L15)       | 4   | 002-205-812 |
| 027S | SCREW - M/P (M5*L15)        | 10  | 002-210-035 | 141  | WASHER - SP (M8)                 | 4   | 003-302-010 |
| 027T | BRACKET                     | 5   | 101-110-281 | 142  | WASHER - F (D17*D8.3*T2)         | 4   | 003-301-038 |
| 040  | STICKER - WARNING           | 1   | P711-040    | 143  | GUIDE BRACKET                    | 2   | P711-143    |
| 043  | RUBBER CUSHION              | 1   | A951-84     | 143R | RUBBER SHOCK                     | 2   | P711-143R   |
| 043R | STICKER - ROUND             | 2   | E850-177    | 144  | GUIDE TUBE                       | 2   | P711-144    |
| 044  | SCREW - P (M5*P0.8*L12)     | 2   | 002-211-255 | 145  | WEIGHT STACK CUSHION             | 2   | A911-07     |
| 046  | PASTIC RIVET                | 4   | 000-076-990 | 146  | SCREW - B/H (M8*P1.25*L20)       | 4   | 002-205-820 |
| 049  | WASHER - F (D27*D6.3*T3.0)  | 2   | 003-301-008 | 147  | WASHER - SP (M8)                 | 4   | 003-302-010 |
| 050  | BOTTLE HOLDER (NEW STYLE)   | 1   | 090-530-500 | 148  | WASHER - F (D17*D8.3*T2)         | 4   | 003-301-038 |
| 050T | SCREW - M/P (M4*L12)        | 4   | 002-210-003 | 149  | GUIDE BRACKET                    | 2   | P711-149    |
| 051  | SCREW - M/H (M5*L20)        | 2   | 002-203-051 | 150  | ADJUSTMENT KNOB                  | 1   | A911-28     |
| 058  | BUSHING                     | 2   | A911-36     | 151  | STICKER - WARNING                | 2   | 082-063-030 |
| 059  | STACK GUIDE TUBE            | 2   | P711-059    | 152  | TAPE - FOAM                      | 2   | 000-065-142 |
| 060  | CUSHION RING                | 2   | A911-37     | 154  | SCREW - M/H (M6*P1.0*L12)        | 8   | 002-203-027 |
| 061  | GUIDE RING                  | 4   | A911-38     | 155  | WASHER - SP (M6)                 | 8   | 003-302-011 |
| 062  | WEIGHT STACK PLATE          | 1   | P711-062    | 156  | COVER - GREY                     | 4   | P711-156G   |
| 063  | 19-POSITION ROD             | 1   | P711-063    | 157  | SCREW - M/H (M6*P1.0*L12)        | 16  | 002-203-027 |
| 064  | NUT - H/N (M8)              | 2   | 001-101-080 | 158  | WASHER - SP (M6)                 | 16  | 003-302-011 |
| 065  | AXLE                        | 2   | 005-730-010 | 159  | WASHER - F (D20*D6.3*T1.5)       | 16  | 003-301-043 |
| 066  | WASHER - F (D17*D8.3*T2)    | 4   | 003-301-038 | 160  | BUSHING                          | 16  | DF-107-055  |
| 067  | SCREW - H (M8*P1.25*L65)    | 2   | 002-206-068 | 161  | AXLE                             | 8   | DF-107-053  |
| 068  | SCREW - B/H (M5*P0.8*L10)   | 2   | 002-205-510 | 162  | GUIDE ROLLER                     | 8   | DF-107-054  |
| 069  | CABLE BRACKET               | 1   | A911-055    | 163  | SCREW - M/H (M6*P1.0*L12)        | 4   | 002-203-027 |
| 070  | SCREW - H (M6*P1.0*L75)     | 2   | 002-230-670 | 164  | WASHER - F (D20*D6.3*T1.5)       | 4   | 003-301-043 |
| 071  | WASHER - SP (M6*T1.5)       | 2   | 003-302-002 | 165  | WASHER - SP (M6)                 | 4   | 003-302-011 |

| BBL | Description                     | QTY | Part Number | BBL | Description           | QTY | Part Number |
|-----|---------------------------------|-----|-------------|-----|-----------------------|-----|-------------|
| 166 | AXLE                            | 2   | DF-107-052  | 484 | FRAME ASSEMBLY - GREY | 1   | 101-191-84K |
| 168 | WASHER - F (D17*D8.3*T1)        | 2   | 003-301-044 | 485 | WHEEL                 | 8   | P711-485    |
| 169 | AXLE                            | 1   | 096-713-090 | 486 | AXLE                  | 1   | DF-107-058  |
| 170 | SNAP RING - (7MM)               | 2   | 004-402-011 | 487 | FRAME - GREY          | 1   | 196-791-09K |
| 172 | WASHER - F (D22*D8.2*T2)        | 4   | 003-301-042 | 488 | AXLE                  | 2   | P711-488    |
| 173 | WASHER - SP (M8)                | 4   | 003-302-010 | 489 | KNEE FRAME - GREY     | 1   | P711-489G   |
| 174 | SCREW - M/H (M8*P1.25*L25)      | 4   | 002-203-061 | 490 | KNEE CUSHION - BLACK  | 1   | P711-490B   |
| 176 | STICKER - WARNING               | 1   | 091-163-020 |     |                       |     |             |
| 177 | END CAP                         | 2   | A933-41     |     |                       |     |             |
| 179 | RUBBER GRIP                     | 2   | P711-179    |     |                       |     |             |
| 180 | SCREW - H (M5*L5)               | 2   | 002-204-064 |     |                       |     |             |
| 182 | RUBBER COVER                    | 2   | A915-50     |     |                       |     |             |
| 187 | SCREW - B/H (M10*L20)           | 5   | 002-205-320 |     |                       |     |             |
| 188 | WASHER - SP (M10)               | 5   | 003-302-008 |     |                       |     |             |
| 189 | WASHER - F (D21*D10.5*T2)       | 5   | 003-301-001 |     |                       |     |             |
| 192 | CONNECTOR PLATE - GREY          | 2   | P711-192G   |     |                       |     |             |
| 193 | FRAME FOOT - GREY               | 2   | 101-150-04K |     |                       |     |             |
| 194 | NUT - H (M10)                   | 2   | 001-102-141 |     |                       |     |             |
| 195 | LEVELER                         | 2   | DF-101-159  |     |                       |     |             |
| 196 | NUT - H/N (M10)                 | 8   | 001-101-030 |     |                       |     |             |
| 197 | WASHER - F (D16*D10.2*T1.0)     | 16  | 003-301-141 |     |                       |     |             |
| 198 | WASHER - SP (M10)               | 8   | 003-302-008 |     |                       |     |             |
| 199 | SCREW - H (M10*P1.5*L130)       | 8   | 002-206-082 |     |                       |     |             |
| 200 | SUPPORT FRAME - GREY            | 2   | P711-200G   |     |                       |     |             |
| 201 | FOOT PAD                        | 2   | DF-101-035  |     |                       |     |             |
| 202 | PASTIC RIVET                    | 4   | 000-076-990 |     |                       |     |             |
| 203 | RUBBER PAD                      | 2   | A911-53     |     |                       |     |             |
| 401 | MAIN FRAME ASSEMBLY - GREY      | 1   | 101-191-10K |     |                       |     |             |
| 402 | TOP COVER ASSEMBLY              | 1   | 101-191-020 |     |                       |     |             |
| 403 | TOP COVER - RIGHT               | 1   | 101-191-030 |     |                       |     |             |
| 404 | TOP COVER - LEFT                | 1   | 101-191-040 |     |                       |     |             |
| 405 | AXLE                            | 1   | DF-103-426  |     |                       |     |             |
| 406 | BOTTLE HOLDER                   | 1   | P711-406    |     |                       |     |             |
| 407 | REAR COVER                      | 1   | P711-407    |     |                       |     |             |
| 410 | BRACKET                         | 3   | P711-410    |     |                       |     |             |
| 411 | MAIN FRAME - GREY               | 1   | 101-191-11K |     |                       |     |             |
| 412 | BRACKET                         | 5   | P711-412    |     |                       |     |             |
| 413 | HANDLE - GREY                   | 2   | P711-413G   |     |                       |     |             |
| 414 | RUBBER FOOT                     | 2   | P711-414    |     |                       |     |             |
| 415 | TUBE HARDWARE                   | 2   | P711-415    |     |                       |     |             |
| 416 | WEIGHT STACK PLATE              | 1   | P711-416    |     |                       |     |             |
| 417 | CABLE BRACKET                   | 1   | S972-406    |     |                       |     |             |
| 418 | SET FORK                        | 1   | P711-418    |     |                       |     |             |
| 420 | SELECTOR FORK - W/CORD          | 1   | A911-50     |     |                       |     |             |
| 421 | SELECTOR FORK - NO CORD         | 1   | 190-591-530 |     |                       |     |             |
| 422 | WEIGHT PLATE - 5KG              | 19  | S911-419    |     |                       |     |             |
| 423 | PLATE STICKER - 5-100KG (GREEN) | 1   | 103-191-230 |     |                       |     |             |
| 424 | COVER HARDWARE                  | 1   | S912-404    |     |                       |     |             |
| 430 | STRENGTH CABLE                  | 1   | P711-430    |     |                       |     |             |
| 481 | HANDLEBAR - GREY                | 1   | P711-481G   |     |                       |     |             |
| 482 | FRAME FOOT - GREY               | 2   | P711-482G   |     |                       |     |             |

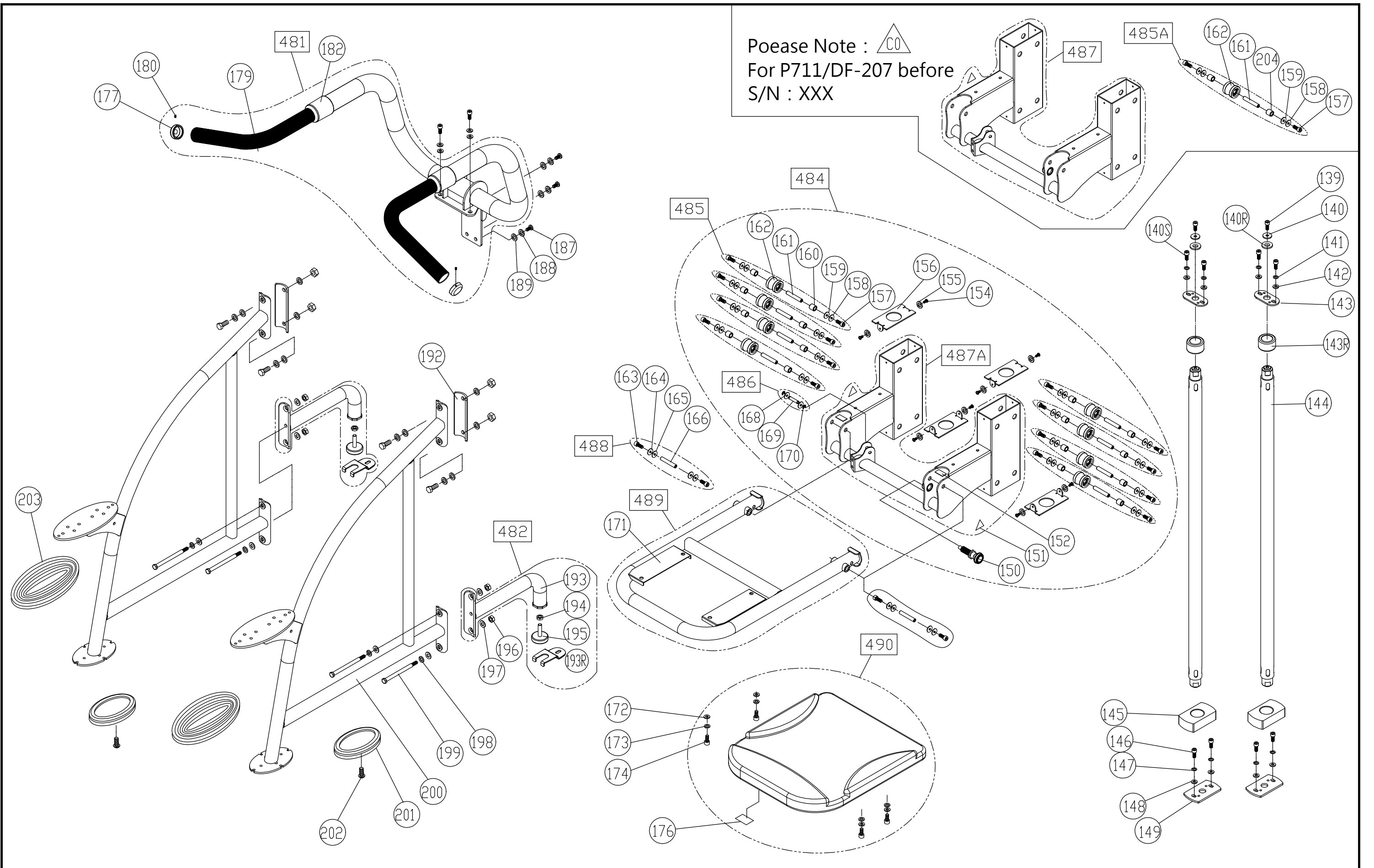



| CHANGE DATE | CHANGE DESCRIPTION                    | CHANGE NO.   | NAME | <br>RESTRICTED USAGE ,<br>PLEASE DON'T FORWARD TO ANYONE WHO ISN'T AUTHORIZED | DRAWN BY    | UNITS   | MM   | SALES BLOW UP DIAGRAM | DIAGRAM NO. | GCH-F101C-C<br>P711/DF-207 |       |
|-------------|---------------------------------------|--------------|------|--|-------------|---------|------|-----------------------|-------------|----------------------------|-------|
| 2015.12.09  | $\triangle B0$ 增加機台固定性, 故 482 新增 193R | 05-20151101M | 鄭宜峰  |  | VERIFIED BY | QTY     | 1    |                       | XX          |                            | MODEL |
| 2016.04.07  | $\triangle B1$ 新增適用機種DF-207           |              | 林士文  |  |             | VERSION | C0   |                       |             |                            |       |
| 2017.02.15  | $\triangle C0$ 如設變單所示修改               | 05-20170204M | 林雅青  |  |             | RATIO   | 1:10 |                       |             |                            |       |